

RF Basic set



Delivery content

- 1x RF-R 400-1, 磁场探头 (30MHz-3GHz)
- 1x RF-R 3-2, 磁场探头 (30MHz-3GHz)
- 1x RF-B 3-2, 磁场探头 (30MHz-3GHz)
- 1x RF-U 2.5-2, 磁场探头 (30MHz-3GHz)
- 1x RF-E 02, 电场探头 (30MHz-3GHz)
- 1x RF-E 05, 电场探头 (30MHz-3GHz)
- 1x SMB-BNC 1 m, SMB-BNC 测量电缆
- 1x Case 5

Technical parameters

频率范围	30 MHz ... 3 GHz
接口	SMB, male, jack
重量	400 g
尺寸(L x W x H)	(24 x 19.5 x 6) cm

RF Basic set

Measurement set-up near field probe

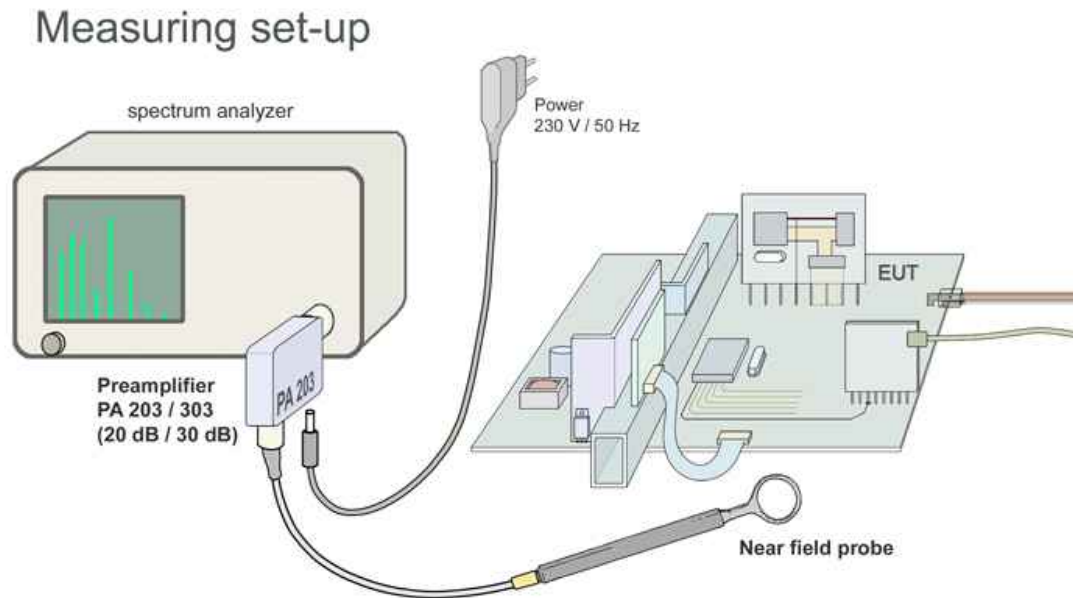

Application RF-U 2,5-2

